

STUDIO TECNICO ATORINO

PROGETTO: Proposta intervento edilizio Maria De Mattias Spiritual and Social Center  
Morogoro

DITTA PROPRIETARIA: Missionary Sisters Adorers of Blood of Christ.

Planimetria Generale

scala 1:600

Proposta 1

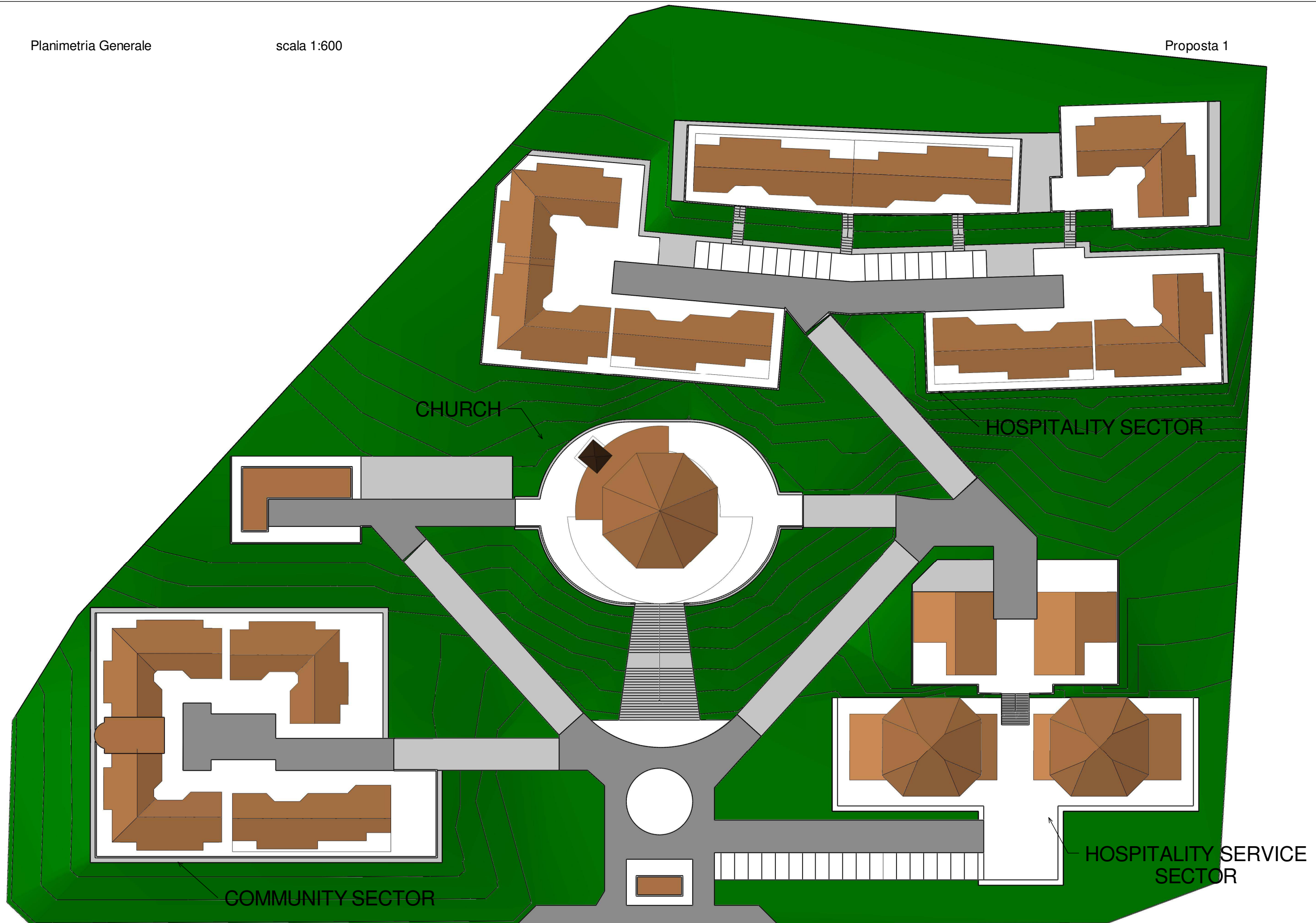



Vista Assonometrica

Proposta 1

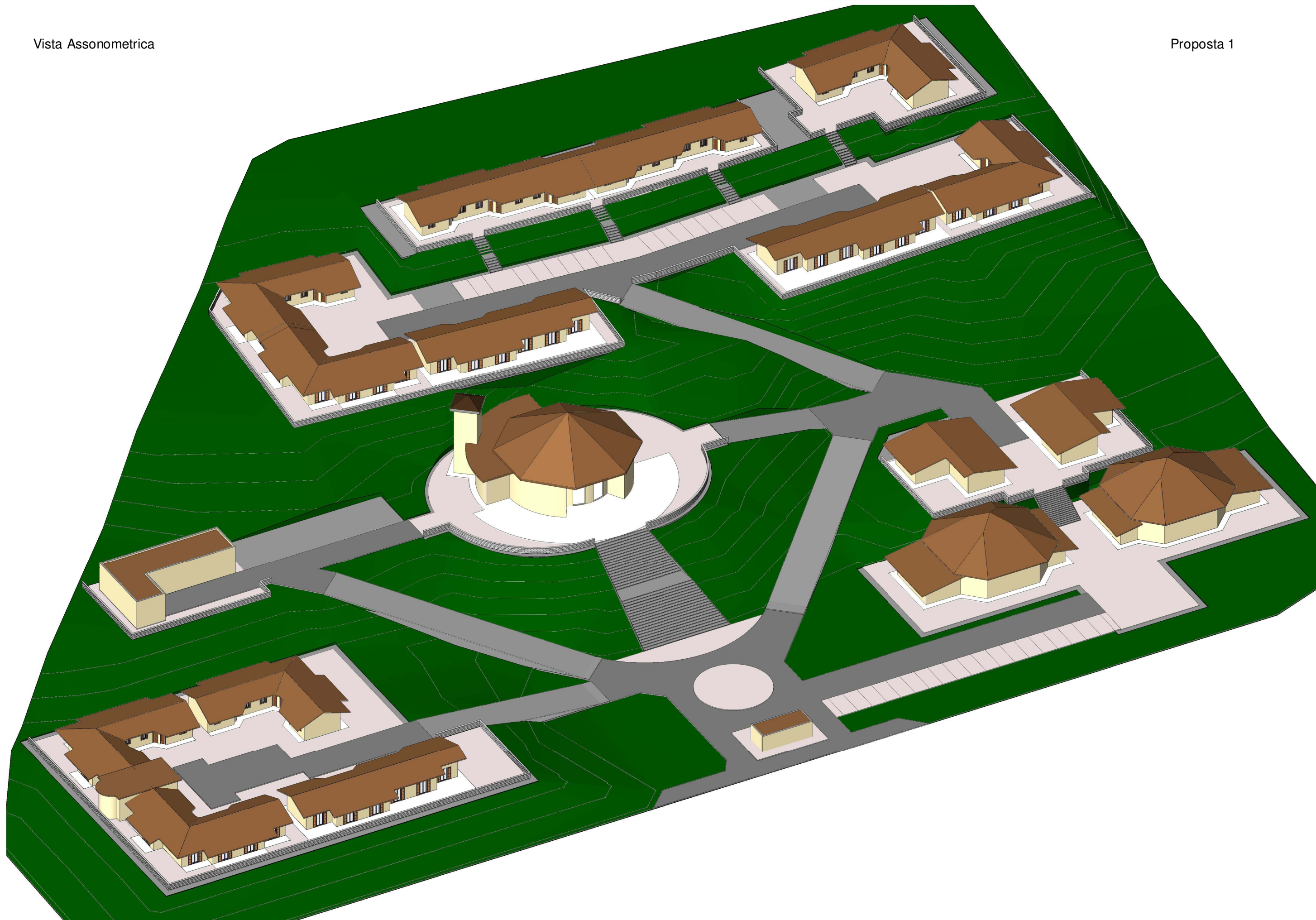



Vista Assonometrica

Proposta 1

